

NOT FOR SAMPLE CONSTRUCTION

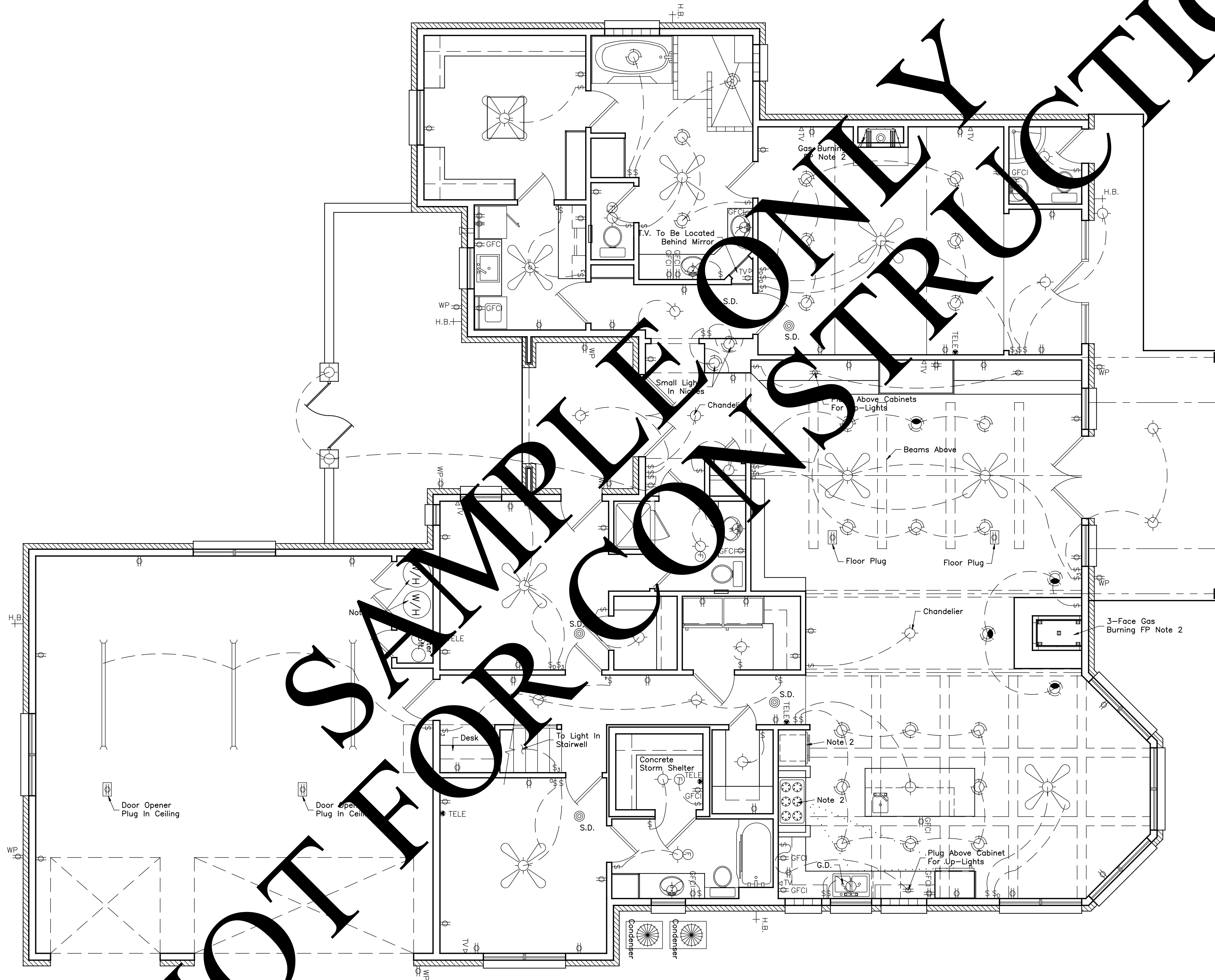

NOTES

- 1) All construction work to be done in accordance with federal, state and local building codes as enforced by the local code officials.
- 2) All built in appliances and mechanical equipment shall be installed according to their manufacturer's instructions. Plugs and connections for the appliances have been omitted for clarity.
- 3) Ceiling fans, as noted, are to have a wall mounted toggle switch for the light and a separate wall mounted dimmer switch for the fan motor.
- 4) All fixture styles and colors shall be as per owner specifications.
- 6) Wall mounted outlets shall be located at a maximum height of 46" and a Minimum height of 16".
- 7) Telephone jacks shall be mounted at a maximum height of 48".
- 8) Switches and thermostats shall be mounted at a maximum height of 48".

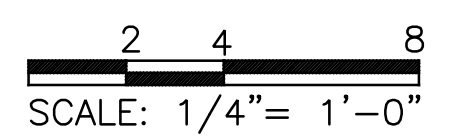

"But the fruit of the Spirit is love, joy, peace, longuffering, gentleness, goodness, faith, 23 Meekness, temperance: against such there is no law." Galatians 5:22,23

**BOB & TINA FRITTS**  
**CUSTOM HOME PLANS**  
 DWG. BY: D. Loveday  
 DATE: 06-25-05  
 DWG. NO: 0506-ELECTRICAL

**LOVEDAY**  
**DESIGNS**  
 Phone (580) 252-0489  
 dgloveday@sbcglobal.net  
 1217 North 11th Street  
 Duncan, OK. 73533

**SHEET**  
 11 / 11